

- NOTES**
- THIS DRAWING IS TO BE READ IN CONJUNCTION WITH ALL OTHER RELEVANT ENGINEERING DRAWINGS. ANY DISCREPANCIES, ERRORS OR OMISSIONS TO BE BROUGHT TO THE ATTENTION OF THE EMPLOYER.
  - ALL DIMENSIONS TO BE CHECKED BY THE CONTRACTOR ON SITE PRIOR TO COMMENCEMENT OF WORKS.
  - EMPLOYER'S REPRESENTATIVE TO BE INFORMED BY THE CONTRACTOR OF ANY DISCREPANCIES PRIOR TO THE COMMENCEMENT OF WORKS ON SITE.
  - DIMENSIONS OF ALL BOUNDARIES AND ADJOINING ROADS TO BE CHECKED ON SITE PRIOR TO COMMENCEMENT OF WORKS.
  - DO NOT SCALE. ALL MEASUREMENTS AND COORDINATES TO BE CHECKED ON SITE.
  - EXISTING FENCE LINES ARE INDICATIVE AND ARE TO BE CONFIRMED ON SITE. EXISTING FENCING IS TO BE REVIEWED ON SITE AND REPLACED WHERE REQUIRED.
  - EMERGENCY ACCESS POINTS ARE TO BE CLOSED OFF WITH DEMOUNTABLE BOLLARDS. KEYS TO BE HANDED OVER TO THE OVERSEEING ORGANISATION.
  - EGREENWAY DRAINAGE IS TO BE OVER THE EDGE DRAINAGE.
  - PROPOSED FENCELINE TO BE ERECTED IN ACCORDANCE WITH TII STANDARD DETAIL CC-SCD-00303

**ISSUE/REVISION**

I/R	DATE	DESCRIPTION
D	DEC 2023	ABP RFI UPDATE
C	MAY 2023	ABP RFI UPDATE
B	MAY 2020	ISSUED FOR INFORMATION
A	APRIL 2020	ISSUED FOR INFORMATION

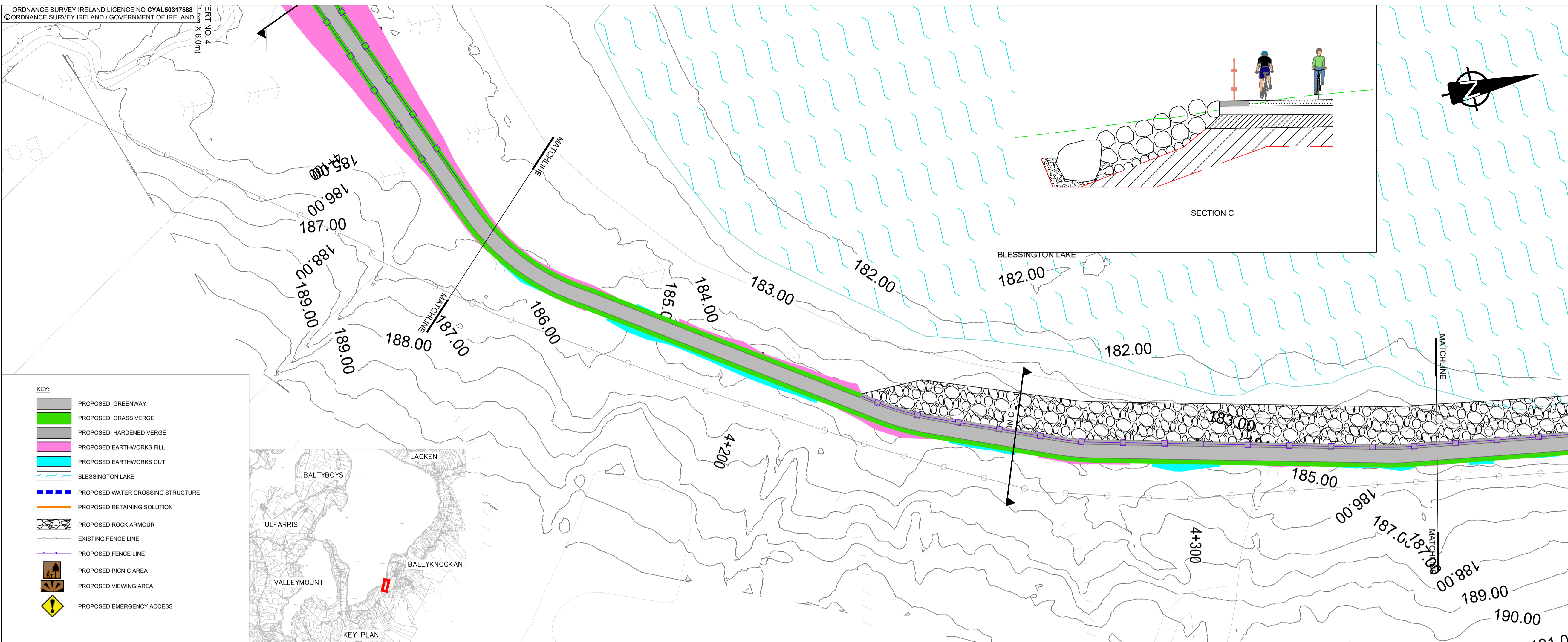

**PHASE 1 - CL LONGSECTION**  
SCALE: H 1:1000, V 1:200

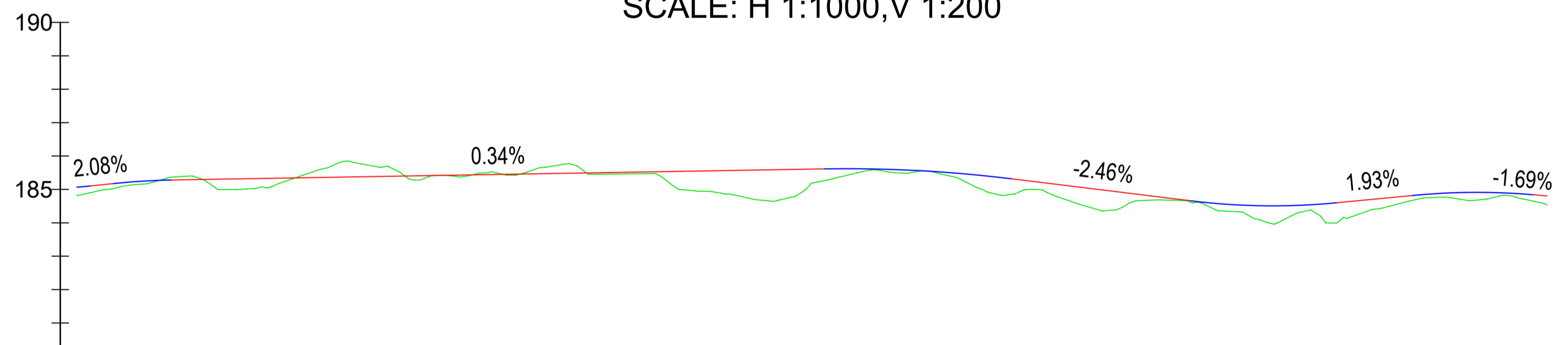

CHAINAGE	4130.000	4150.000	4200.000	4250.000	4300.000	4350.000
EXISTING LEVELS	184.814	185.151	185.662	185.574	184.431	184.536
PROPOSED LEVELS	185.065	185.300	185.471	185.608	184.588	184.805
VERTICAL ALIGNMENT	L=33.34 K=5.00 G=0.34%		G=0.34% 1:293.6		L=28.00 K=10.00 G=-2.46% -1.40.7	L=21.934 K=5.00 G=1.93% 1:51.9